

## **NOTICE OF MEETING**

### **Overview and Scrutiny Commission**

**Wednesday 21 September 2011, 6.00 pm**

**Function Room, Fifth Floor, Easthampstead House, Town Square,  
Bracknell**

### **To: OVERVIEW AND SCRUTINY COMMISSION**

Councillor Leake (Chairman), Councillor Angell (Vice-Chairman), Councillors Mrs Angell, Mrs Birch, Ms Brown, Finnie, Harrison, Heydon, McLean, Turrell, Virgo and Ms Whitbread

#### **Children's Social Care Representative**

Ms C Mitchell

#### **Church Representative Members** (Voting in respect of Education matters only)

Mr D Moss and One Vacancy

#### **Parent Governor Representative Members** (Voting in respect of education matters only)

Ms S Cauchi and Dr P Josephs-Franks

#### **cc: Substitute Members of the Commission**

Councillors Allen, Baily, Kensall, Ms Miller, Mrs Temperton and Worrall

#### **Executive Member invited:**

Councillor Birch

ALISON SANDERS  
Director of Corporate Services

### **EMERGENCY EVACUATION INSTRUCTIONS**

- 1 If you hear the alarm, leave the building immediately.
- 2 Follow the green signs.
- 3 Use the stairs not the lifts.
- 4 Do not re-enter the building until told to do so.

If you require further information, please contact: Sue Hills  
Telephone: 01344 352060  
Email: [sue.hills@bracknell-forest.gov.uk](mailto:sue.hills@bracknell-forest.gov.uk)  
Published: 16 September 2011



**Overview and Scrutiny Commission  
Wednesday 21 September 2011, 6.00 pm  
Function Room, Fifth Floor, Easthampstead House, Town  
Square, Bracknell**

**AGENDA**

Page No

**In order to comply with the requirement of the Council's Constitution to hold a meeting of the Overview and Scrutiny Commission within seven working days of a request to call in a decision, it has not been possible to give five clear working days' notice of the meeting.**

**1. Apologies for Absence/Substitute Members**

To receive apologies for absence and to note the attendance of any substitute members.

**2. Declarations of Interest and Party Whip**

Members are asked to declare any personal or prejudicial interests and the nature of that interest, including the existence and nature of the party whip, in respect of any matter to be considered at this meeting.

**3. Call- In of Executive Decision - Implementation of Older Persons Accommodation and Support Services Strategy**

The Chairman has agreed to take this as an urgent item in order to comply with the requirements of the Council's Constitution.

1 - 20

## OVERVIEW AND SCRUTINY COMMISSION 21 SEPTEMBER 2011

---

### CALL- IN OF EXECUTIVE DECISION – IMPLEMENTATION OF OLDER PERSONS ACCOMMODATION AND SUPPORT SERVICES STRATEGY

#### Assistant Chief Executive

#### 1 PURPOSE OF DECISION

To consider the Executive's decision 1030320, concerning the implementation of the Older Persons Accommodation and Support Services Strategy, which has been called – In at the request of Councillors Leake, Angell, McLean and Virgo. The Council's Constitution requires that the Overview and Scrutiny Commission shall review the Executive's decision within 7 working days of the decision to call-in. If, having considered the decision, the Commission is concerned about it, then it may refer it back to the Executive for reconsideration, setting out in writing the nature of its concerns, or refer the matter to full Council.

#### 2 RECOMMENDATIONS

**That the Overview and Scrutiny Commission:**

- 2.1 **Invites the Councillors requesting the Call-In to explain their concerns over the Executive decision.**
- 2.2 **Invites the Executive Member for Adult Services, Health and Housing to comment on Members' concerns.**
- 2.3 **Reviews the Executive's decision and determines whether to refer it back to the Executive, or to full Council.**

#### 3 SUPPORTING INFORMATION

- 3.1 The Overview and Scrutiny (O&S) procedure rules relating to Call-In are in the Council's Constitution at Annex 1.
- 3.2 At its meeting on 6 September the Council's Executive considered the attached report entitled, 'Implementation of Older Persons Accommodation and Support Services Strategy'.
- 3.3 The Executive agreed the recommendations in that report, and the record of the Executive's decision at Annex 2 was published on 7 September, for implementation on 15 September, subject to any Call-In.
- 3.4 On 12 September, Councillor Leake, supported by Councillors Angell, McLean and Virgo, formally notified the Head of Democratic and Registration Services (the 'Proper Officer' under the terms of the Constitution) that he wished to call-in the Executive's

decision at Annex 2. On 14 September, Councillors Leake, McLean and Virgo cited their reasons for the call-in as follows:

That decision 2 of the above [Executive] decision [on the Implementation of Older Persons Accommodation and Support Services Strategy] relating to the Binfield Nursery site does not adequately define important parameters of any proposed scheme alluding to:

1. Density
2. Protection and future use of preserved wall area
3. Indicate suggested percentage of affordable housing or extra care units
4. Makes no reference to provision to relocate loss of existing nursery provision
5. Allude to funding of proposed new surgery and state
6. That release and development of land is conditional on these requirements being met.

- 3.5 Based on that request, the Head of Democratic and Registration Services called-in the Executive decision on 13 September. An additional meeting of the Overview and Scrutiny Commission has been arranged at short notice as under the Constitution, the Commission have until Thursday 22 September to consider the Call-In. The Council's Executive Member for Adult Services, Health and Housing will be present. Officer attendance will include the Chief Executive, and the Chief Officer: Housing.
- 3.6 A special meeting of the Executive has been provisionally arranged for 5.00pm on 27 September 2010, which will consider any views the Commission may wish to submit to it.

#### **4 ADVICE RECEIVED FROM STATUTORY OFFICERS**

##### Borough Solicitor

- 4.1 Under the executive arrangements that the Council was required to adopt under Part II of the Local Government Act 2000, the legislative intention is that the full council will determine its policy framework (through approval or adoption of a series of plans or strategies) and its budget; the executive is then responsible for implementation of the policy framework. The Constitution the Council adopted reflects this division of responsibilities.
- 4.2 The Local Authorities (Functions and Responsibilities) (England) Regulations 2000 provide that many functions relating to town and country planning and development control (including powers to determine or decline applications for planning permission) are not to be the responsibility of an Authority's executive. Decisions on these planning matters are the responsibility of the Planning Committee in this Council and cannot be taken by the Executive.
- 4.3 Therefore, neither the Executive nor full Council may amend the Executive's decision to address the concerns expressed as reasons for the call-in which relates to responsibilities of the Planning Committee. The decision that was made was an Executive decision for which the Executive and not the Council is responsible. As stated in the Constitution, if the decision were referred to full Council and Council objected to the decision, Council could not itself make a different decision unless the Executive

decision was contrary to the policy framework, and this decision does not appear to be contrary. Council could refer the decision back to the Executive together with its views.

Background Papers

Local Government Act 2000

Contact for further information

Richard Beaumont – 01344 352283

e-mail: [richard.beaumont@bracknell-forest.gov.uk](mailto:richard.beaumont@bracknell-forest.gov.uk)

**Bracknell Forest Council Constitution (Extract)**

**Part 3**

**2.2 Terms of Reference**

The Overview and Scrutiny Commission shall:

(iii) review decisions made, but not yet implemented, by the Executive and any other Committee, where these have been called-in.

**Part 4 Section 9 – Overview And Scrutiny Procedure Rules**

**20 Call-in**

a) When a decision is made by the Executive, an individual member of the Executive or a committee of the Executive, or a Key Decision is made by an officer with delegated authority from the Executive, or under joint arrangements, the decision shall be published, including where possible by electronic means, and shall be available at the main offices of the Council normally within two working days of being made. The chairmen of the Overview and Scrutiny Commission and overview and scrutiny panels will be sent copies of the records of all such decisions within the same timescale, by the person responsible for publishing the decision.

b) The notice will bear the date on which it is published and will specify that the decision will come into force, and may then be implemented, on the expiry of 5 working days after the date the decision is published, unless the decision is called in as described below.

c) During the period, the proper officer may call-in a decision for scrutiny by the Overview and Scrutiny Commission if so requested by the chairman and any 2 Members of the Overview and Scrutiny Commission, or any 5 Members of the Council and shall then notify the decision-maker and all other Executive members of the call-in, a Member requesting a call-in shall provide the proper officer with a brief written summary of their reasons for the request, and insofar as they are able to do so, briefly set out what action arising from the call-in they wish to be taken. The proper officer shall call a meeting of the Commission on such date as he/she may determine, where possible after consultation with the Commission chairman, and in any case within 7 working days of the decision to call-in.

d) For the purposes of this section, where the decision relates to the exercise of an education function, the duly appointed diocesan representatives and parent governor representatives shall have the same rights to seek or support the calling-in of a decision as any other member of the Overview and Scrutiny Commission.

e) If, having considered the decision, the Commission is still concerned about it, then it may refer it back to the decision making person or body for reconsideration, setting out in writing the nature of its concerns or refer the matter to full Council. If referred back the decision maker shall then reconsider within a further 7 working days, amending the decision or not, before adopting a final decision.

f) If following an objection to the decision, the Overview and Scrutiny Commission does not meet in the period set out above, or does meet but does not refer the matter back to the decision making person or body or to the Council, the decision shall take effect on the date of the meeting, or the expiry of the period in which the meeting should have been held, whichever is the earlier.

g) If the matter was referred to full Council and the Council does not object to a decision which has been made, then no further action is necessary and the decision will be effective in accordance with the provision below. However, if the Council does object, it has no locus to make decisions in respect of an Executive decision unless it is contrary to the policy framework, or contrary to or not wholly consistent with the budget. Unless that is the case, the Council will refer any decision to which it objects back to the decision making person or body, together with the Council's views on the decision. That decision making body or person shall choose whether to amend the decision or not before reaching a final decision and implementing it. Where the decision was made by the Executive, as a whole or a committee of it, a meeting will be convened to reconsider within 7 working days of the Council request. Where the decision was made by an individual, the individual will reconsider within 5 working days of the Council request.

h) If the Council does not meet, or if it does but does not refer the decision back to the decision making body or person, the decision will become effective on the date of the Council meeting or expiry of the period in which the Council meeting should have been held, whichever is the earlier.

i) The call-in procedure set out above shall not apply where the decision being made by the Executive is urgent. A decision will be urgent if any delay likely to be caused by the call in process would seriously prejudice the Council's or the public's interests. The record of the decision, and notice by which it is made public, shall state whether in the opinion of the decision making person or body the decision is an urgent one, and therefore not subject to call-in. The Mayor must agree both that the decision proposed is reasonable in all the circumstances and to it being treated as a matter of urgency. In the absence of the Mayor, the Deputy Mayor's consent shall be required. In the absence of both, the head of paid service or his/her nominee's consent shall be required. Decisions made as a matter of urgency must be reported to the next available meeting of the Council, together with the reasons for urgency.

j) The operation of the provisions relating to call-in and urgency shall be monitored annually, and a report submitted to Council with proposals for review if necessary.

Annex 2

**Bracknell Forest Council  
Record of Decision**

|                                 |                |
|---------------------------------|----------------|
| <b>Work Programme Reference</b> | <b>I030320</b> |
|---------------------------------|----------------|

1. **TITLE:** Implementation of Older Persons Accommodation & Support Services Strategy
2. **SERVICE AREA:** Environment, Culture & Communities
3. **PURPOSE OF DECISION**

The purpose of this report is to seek consideration of the use of Council land assets to implement the first stages of the older persons accommodation and support services strategy.

4. **IS KEY DECISION** Yes
5. **DECISION MADE BY:** Executive

6. **DECISION:**

- 1 That the principle of Council owned land at Garth shown at Appendix A being transferred to Bracknell Forest Homes to enable the development of an extra care scheme for older people be agreed.
- 2 That in principle the Binfield Nursery site being developed for residential development subject to planning permission including in part the provision of older persons accommodation be agreed.

7. **REASON FOR DECISION**

At its meeting on the 5 July 2011 Executive agreed the Older Persons Accommodation and Support Services Strategy. It also agreed to programme funding from the stock transfer receipt to support Bracknell Forest Homes developing an extra care scheme for older people.

Bracknell Forest Homes have been successful in receiving £2 million of funding from the Homes and Communities Agency to develop an extra care scheme. The scheme must be completed by March 2015. The Council has agreed to provide £1.5 million of funding towards the development of an extra care scheme funded from the stock transfer receipt, plus the value of the land estimate at approximately £1 million.

The strategy has identified the need for up to 350 units of extra care housing in Bracknell Forest up to 2026. It is estimated that around 250 of those units should be privately owned and the balance affordable housing.

Through consultation with older people it has been established that location is a primary concern of older people in moving to new accommodation. The locations that were identified as first and second priority locations in the borough were Bracknell town centre and Binfield.

The Council has the ability to bring the Garth sites to market for residential development. The potential scale of development on both sites will mean they will both be qualifying sites for the Council's affordable housing policy. The Council's affordable housing planning policy allows an affordable housing obligation to be met by provision of affordable housing on an



alternative site to that being developed. Therefore, the opportunity exists to bring forward the first of the two sites for development including the extra care scheme for older people and in so doing providing the affordable housing obligation for both sites.

By bringing forward the Garth site at Appendix A to provide the affordable housing obligation across both sites it will maximise the value for the Council of both sites and also enable the funding secured by Bracknell Forest Homes to be defrayed before March 2015 which is a condition of the funding. The funding will be released to Bracknell Forest Homes upon completion of the extra care scheme. Therefore, the latest date that Bracknell Forest Homes should start on site is December 2012.

Bracknell Forest Homes are a preferred partner registered provider of the Council. This was achieved via the competition to select preferred partners which took place in 2009/10. Therefore, there has been a competitive process to select the developer of the extra care scheme.

The Binfield nursery site is capable of being brought forward for development if access arrangements are addressed. If the site is brought forward for residential development subject to planning permission it will offer the opportunity to bring forward an extra care scheme for older people which will be predominantly owner occupied. As a qualifying site for affordable housing the Council would negotiate an element of the extra care development as affordable housing so as to achieve the planning obligation.

#### 8. ALTERNATIVE OPTIONS CONSIDERED

The Council could decide to bring the Garth sites to the market without demarcating an element to provide an extra care scheme for older people. This would run the risk of making it more difficult to secure a site for such a provision in Bracknell town centre. It may also lead to provision of a different type of affordable housing offer to meet the affordable housing obligation across both sites which may impact on overall site value. Moreover, delay in bringing the site forward would jeopardise the ability to defray the funding that Bracknell Forest Homes has secured. Without the availability of that funding if the Council wishes to support the scheme inevitably the Council would be required to provide additional funding. Therefore, the recommendations present the best way of maximising the Council's resources.

If access arrangements to the Binfield nursery site are addressed and the site is brought forward for residential development subject to planning permission without demarcating land for an older person's scheme this may mean an alternative form of affordable housing is offered to meet the obligation which may impact on value. Moreover, it may also threaten the Council's ability to achieve the objectives of the Older Person's Accommodation and Support Services Strategy where older people have indicated Binfield as a preferred location.

9. **PRINCIPAL GROUPS CONSULTED:** Older people and residents.

10. **DOCUMENT CONSIDERED:** Report of the Director of Environment, Culture & Communities

11. **DECLARED CONFLICTS OF INTEREST:** None.

| Date Decision Made | Final Day of Call-in Period |
|--------------------|-----------------------------|
| 06 September 2011  | 14 September 2011           |

This page is intentionally left blank

TO: THE EXECUTIVE  
6 SEPTEMBER 2011

---

## IMPLEMENTATION OF OLDER PERSONS ACCOMMODATION AND SUPPORT SERVICES STRATEGY

Director of Environment, Culture and Communities

### 1 PURPOSE OF DECISION

- 1.1 The purpose of this report is to seek consideration of the use of Council land assets to implement the first stages of the Older Persons Accommodation and Support Services Strategy.

### 2 RECOMMENDATIONS

- 2.1 **That the principle of Council owned land at Garth shown at Appendix A being transferred to Bracknell Forest Homes to enable the development of an extra care scheme for older people be agreed.**
- 2.2 **That the Executive agrees in principle the Binfield Nursery site being developed for residential development subject to planning permission including in part the provision of older persons accommodation.**

### 3 REASONS FOR RECOMMENDATIONS

- 3.1. At its meeting on the 5 July 2011 Executive agreed the Older Persons Accommodation and Support Services Strategy. It also agreed to programme funding from the stock transfer receipt to support Bracknell Forest Homes developing an extra care scheme for older people.
- 3.2. Bracknell Forest Homes have been successful in receiving £2 million of funding from the Homes and Communities Agency to develop an extra care scheme. The scheme must be completed by March 2015. The Council has agreed to provide £1.5 million of funding towards the development of an extra care scheme funded from the stock transfer receipt, plus the value of the land estimate at approximately £1 million.
- 3.3. The strategy has identified the need for up to 350 units of extra care housing in Bracknell Forest up to 2026. It is estimated that around 250 of those units should be privately owned and the balance affordable housing.
- 3.4. Through consultation with older people it has been established that location is a primary concern of older people in moving to new accommodation. The locations that were identified as first and second priority locations in the borough were Bracknell town centre and Binfield.
- 3.5. The Council has the ability to bring the Garth sites to market for residential development. The potential scale of development on both sites will mean they will both be qualifying sites for the Council's affordable housing policy. The Council's affordable housing planning policy allows an affordable housing obligation to be met by provision of affordable housing on an alternative site to that being developed. Therefore, the opportunity exists to bring forward the first of the two sites for

development including the extra care scheme for older people and in so doing providing the affordable housing obligation for both sites.

- 3.6 By bringing forward the Garth site at Appendix A to provide the affordable housing obligation across both sites it will maximise the value for the Council of both sites and also enable the funding secured by Bracknell Forest Homes to be defrayed before March 2015 which is a condition of the funding. The funding will be released to Bracknell Forest Homes upon completion of the extra care scheme. Therefore, the latest date that Bracknell Forest Homes should start on site is December 2012.
- 3.7 Bracknell Forest Homes are a preferred partner registered provider of the Council. This was achieved via the competition to select preferred partners which took place in 2009/10. Therefore, there has been a competitive process to select the developer of the extra care scheme.
- 3.8 The Binfield nursery site is capable of being brought forward for development if access arrangements are addressed. If the site is brought forward for residential development subject to planning permission it will offer the opportunity to bring forward an extra care scheme for older people which will be predominantly owner occupied. As a qualifying site for affordable housing the Council would negotiate an element of the extra care development as affordable housing so as to achieve the planning obligation.

#### **4 ALTERNATIVE OPTIONS CONSIDERED**

- 4.1. The Council could decide to bring the Garth sites to the market without demarcating an element to provide an extra care scheme for older people. This would run the risk of making it more difficult to secure a site for such a provision in Bracknell town centre. It may also lead to provision of a different type of affordable housing offer to meet the affordable housing obligation across both sites which may impact on overall site value. Moreover, delay in bringing the site forward would jeopardise the ability to defray the funding that Bracknell Forest Homes has secured. Without the availability of that funding if the Council wishes to support the scheme inevitably the Council would be required to provide additional funding. Therefore, the recommendations present the best way of maximising the Council's resources.
- 4.2. If access arrangements to the Binfield nursery site are addressed and the site is brought forward for residential development subject to planning permission without demarcating land for an older person's scheme this may mean an alternative form of affordable housing is offered to meet the obligation which may impact on value. Moreover, it may also threaten the Council's ability to achieve the objectives of the Older Person's Accommodation and Support Services Strategy where older people have indicated Binfield as a preferred location.

#### **5 SUPPORTING INFORMATION**

##### Older person accommodation and support services strategy

- 5.1 At its meeting on the 5 July the Executive agreed the Older Person Accommodation and Support Services Strategy. The strategy identified the need to extend the offer of accommodation for older people in Bracknell Forest by the provision of extra care housing. An initial estimate was that there is a demand for around 350 units of extra care housing for older people up to 2026. In terms of tenure it is estimated that 250 of

those units should be for owner occupation and the remaining being affordable housing.

- 5.2. Older people were asked what were important factors in terms new housing provision. Location was a key factor. They were also asked their preference in terms of location and they indicated that the most popular location would be Bracknell town centre followed by Binfield.

#### Garth school site

- 5.3. Members will be aware that as part of the assessment of the requirement for school playing fields for the new Garth Hill college land was set aside for future disposal. This would create additional funding for the build costs of the new school.
- 5.4. There are in fact potentially two sites. It is possible to bring forward one of the sites before the other and if the affordable housing obligation across both sites is provided on that first site, it is likely to improve the attractiveness of the second site to potential bidders. Appendix A shows the part of the site that could be brought forward in advance for the extra care scheme.

#### 5.5. Binfield Nursery site

- 5.6. The Binfield Nursery site is shown at Appendix B. The Council has been approached by a developer who has secured options on the privately owned land at the south of the council owned site. The developer has also been in negotiation with the doctor's surgery and primary care trust at the front of the site about provision of an improved facility. The developer has approached the Council with proposals to develop the Council owned site alongside development of a new and improved surgery.
- 5.7. The Council's nursery function operates from the site. It occupies 1.7 acres and comprises of a greenhouse and two polytunnels and associated work sheds and staff welfare facilities. Development of the site will require the Council to review how it acquires the necessary stock for its planting requirements which could range from relocation based on existing operations to whole sale purchase of plants. If members are minded to agree disposal, officers will develop proposals to maintain the service either via relocation or reprovision. Timing will be critical and the solution to ongoing provision of the service should be in place by July/ August 2012.
- 5.8. Formal pre-application discussions with the developer are anticipated in early September, following agreement to recommendations of this report.

## **6 ADVICE RECEIVED FROM STATUTORY AND OTHER OFFICERS**

### Borough Solicitor

- 6.1 Nothing to add to the report

### Borough Treasurer

- 6.2 The report seeks agreement, in principle, to the disposal of two Council owned sites at Garth Hill College and Binfield Nursery. The detailed financial implications arising from these disposals will form part of the business case that is to be presented to the Executive before disposal takes place. Based on the advice of the Chief Officer: Property the remainder of the Garth Hill College site should generate a capital receipt that is in line with previous expectations.

### Equalities Impact Assessment

- 6.3 A equalities impact assessment screening form accompanies this report.

### Strategic Risk Management Issues

- 6.4 The report proposes ways in which to achieve the objectives of the Council's Older Person Accommodation and Support Services Strategy whilst maximising asset values. In particular failure to achieve a suitable site for an extra care scheme with Bracknell forest homes to enable development to be completed by 2015 may lead to the Council being required to make available an increased amount of the stock transfer receipt.

## **7 CONSULTATION**

### Principal Groups Consulted

- 7.1 Older people were consulted to formulate the older person accommodation and support services strategy.

### Method of Consultation

- 7.2 Older people were consulted via questionnaires

### Representations Received

- 7.3 The responses are included in the Older Person Accommodation and Support Services Strategy.

### Background Papers

Older Person Accommodation and Support Services Strategy.

### Contact for further information:

Simon Hendey Chief officer: Housing  
Simon.hendey@bracknell-forest.gov.uk  
Tel 01344 351688

## Equalities Screening Record Form

|  |  |   |
|--|--|---|
| <b>Date of Screening:</b>  | <b>Directorate:</b><br>ECC   | <b>Section: Housing</b>   |
| <b>1. Activity to be assessed</b>  | Please give full details of the activity and summarise the budget reduction proposal   |   |
| <b>2. What is the activity?</b>  | <input type="checkbox"/> Policy/strategy <input type="checkbox"/> Function/procedure <input checked="" type="checkbox"/> Project <input type="checkbox"/> Review <input type="checkbox"/> Service <input type="checkbox"/> Organisational change |   |
| <b>3. Is it a new or existing activity?</b>  | x New <input type="checkbox"/> Existing  |   |
| <b>4. Officer responsible for the screening</b>  | Simon Hendey   |   |
| <b>5. Who are the members of the EIA team?</b>   | Clare Dorning  |   |
| <b>6. What is the purpose of the activity?</b>   | To agree in principle the development of Council owned sites to further the older person accommodation and support services strategy   |   |
| <b>7. Who is the activity designed to benefit/target?</b>  |  |   |
| <b>8. a Racial equality - Is there an impact?</b><br>What kind of equality impact may there be?<br>Is the impact positive or adverse or is there a potential for both? If the impact is neutral please give a reason.      |  | The decision is to agree in principle for council owned sites to be developed to further the implementation of the older person accommodation and support services strategy. Until schemes are designed and shown to be viable it is not possible to assess impact. |
| <b>8. b What evidence do you have to support this?</b><br>E.g. equality monitoring data, consultation results, customer satisfaction information etc.  |  |   |
| <b>9. a Gender equality - Is there an impact?</b><br>What kind of equality impact may there be?<br>Is the impact positive or adverse or is there a potential for both? If the impact is neutral please give a reason.      |  | The decision is to agree in principle for council owned sites to be developed to further the implementation of the older person accommodation and support services strategy. Until schemes are designed and shown to be viable it is not possible to assess impact. |
| <b>9. b What evidence do you have to support this?</b>   |  |   |
| <b>10. a Disability equality - Is there an impact?</b><br>What kind of equality impact may there be?<br>Is the impact positive or adverse or is there a potential for both? If the impact is neutral please give a reason. |  | The decision is to agree in principle for council owned sites to be developed to further the implementation of the older person accommodation and support services strategy. Until schemes are designed and shown to be viable it is not possible to assess impact. |
| <b>10. b What evidence do you have to support this?</b>  |  |   |
| <b>11. a Age equality - Is there an impact?</b><br>What kind of equality impact may there be?<br>Is the impact positive or adverse or is there a potential for both? If the impact is neutral please give a reason.        | Y  | Subject to a viable scheme there will a positive impact   |
| <b>11. b What evidence do you have to support this?</b>  | The scheme will provide extra care housing for older people as identified as part of the strategy  |   |

|  |                   |                           |  |
|--|-------------------|---------------------------|--|
| <p><b>12. a Religion and belief equality - Is there an impact?</b><br/>         What kind of equality impact may there be?<br/>         Is the impact positive or adverse or is there a potential for both? If the impact is neutral please give a reason.</p>   |                   |                           | <p>The decision is to agree in principle for council owned sites to be developed to further the implementation of the older person accommodation and support services strategy. Until schemes are designed and shown to be viable it is not possible to assess impact.</p> |
| <p><b>12. b What evidence do you have to support this?</b></p>   |                   |                           |  |
| <p><b>13. a Sexual orientation equality - Is there an impact?</b><br/>         What kind of equality impact may there be?<br/>         Is the impact positive or adverse or is there a potential for both? If the impact is neutral please give a reason.</p>  |                   |                           |  |
| <p><b>13. b What evidence do you have to support this?</b></p>   |                   |                           |  |
| <p><b>14. Please give details of any other potential impacts on any other group (e.g. those on lower incomes/carer's/ex-offenders) and on promoting good community relations.</b></p>  |                   |                           |  |
| <p><b>15. If an adverse/negative impact has been identified can it be justified on grounds of promoting equality of opportunity for one group or for any other reason?</b></p>   |                   |                           |  |
| <p><b>16. If there is any difference in the impact of the activity when considered for each of the equality groups listed in 8 – 14 above; how significant is the difference in terms of its nature and the number of people likely to be affected?</b></p>  |                   |                           |  |
| <p><b>17. Could the impact constitute unlawful discrimination in relation to any of the Equality Duties?</b></p>   | N                 |                           |  |
| <p><b>18. What further information or data is required to better understand the impact? Where and how can that information be obtained?</b></p>  |                   |                           |  |
| <p><b>19. On the basis of sections 7 – 17 above is a full impact assessment required?</b></p>  | N                 |                           | It is too early in the process to be able to undertake an assessment   |
| <p><b>20. If a full impact assessment is not required; what actions will you take to reduce or remove any potential differential/adverse impact, to further promote equality of opportunity through this activity or to obtain further information or data? Please complete the action plan in full, adding more rows as needed.</b></p> |                   |                           |  |
| <p><b>Action</b></p>   | <p>Time scale</p> | <p>Person Responsible</p> | <p>Milestone/Success Criteria</p>  |
|  |                   |                           |  |
|  |                   |                           |  |
|  |                   |                           |  |



|   |                              |
|---|------------------------------|
| 21. Which service, business or work plan will these actions be included in?   |                              |
| 22. Have any current actions to address issues for any of the groups or examples of good practice been identified as part of the screening? | Please list                  |
| 23. Chief Officers signature.   | Signature: _____ Date: _____ |
| 24. Which PMR will this screening be reported in?   |                              |

When complete please send to [abby.thomas@bracknell-forest.gov.uk](mailto:abby.thomas@bracknell-forest.gov.uk) for publication on the Council's website.

This page is intentionally left blank

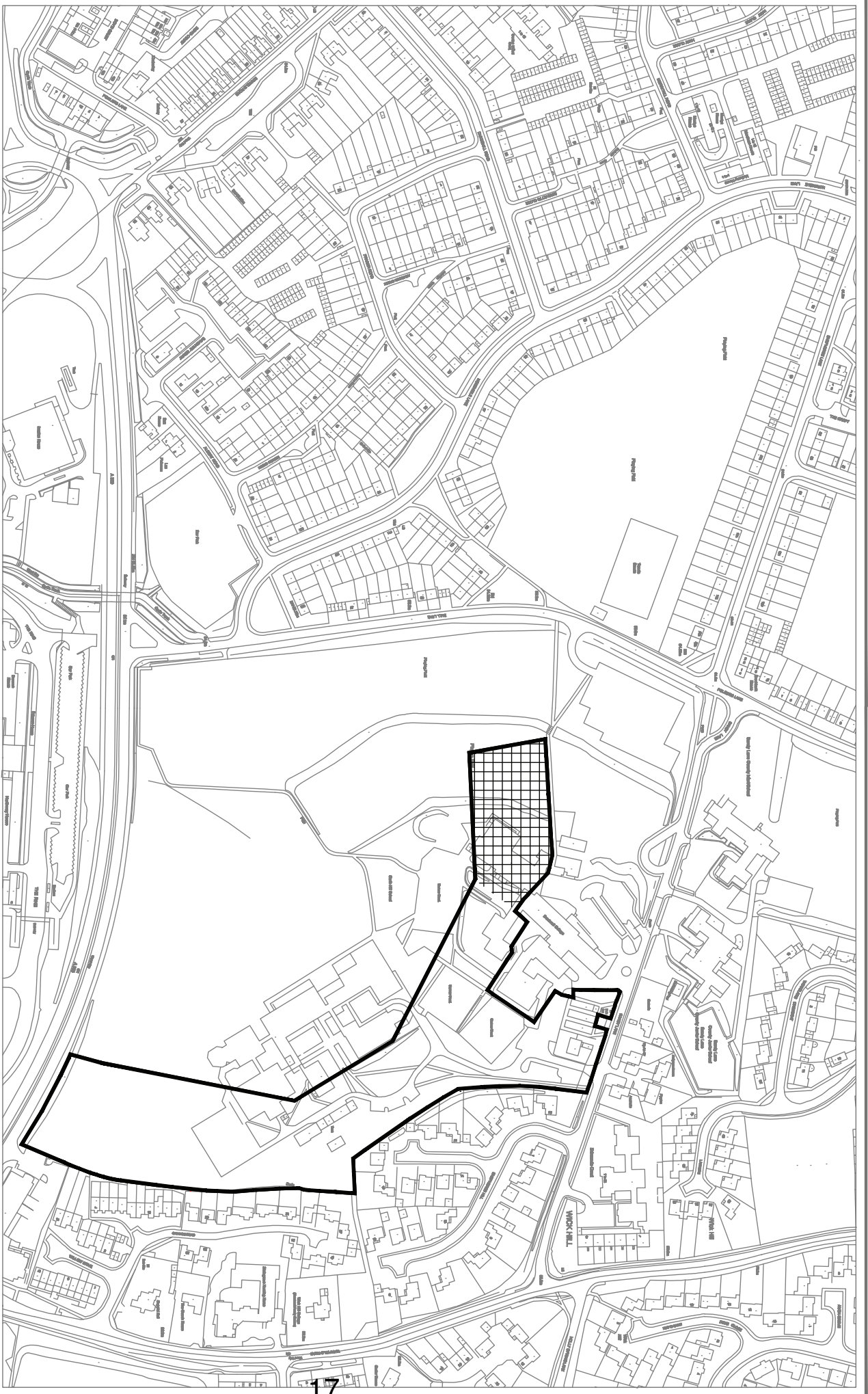

Chief Officer: Property - Sandy Farnham MVRCS

Project Title

**Land Identified for Disposal**

Drawing Title

**Garth Hill School Project**

Land Proposed for Extra Care Facility

Surplus Land for Disposal



|                |                |               |                   |
|----------------|----------------|---------------|-------------------|
| Prepared by    | Checked by     | Scale         | Date              |
| <b>LC</b>      | <b>SLB</b>     | <b>1:2500</b> | <b>25/07/2011</b> |
| Project Number | Drawing Number | Amend         | Print             |
|                |                |               |                   |

This page is intentionally left blank

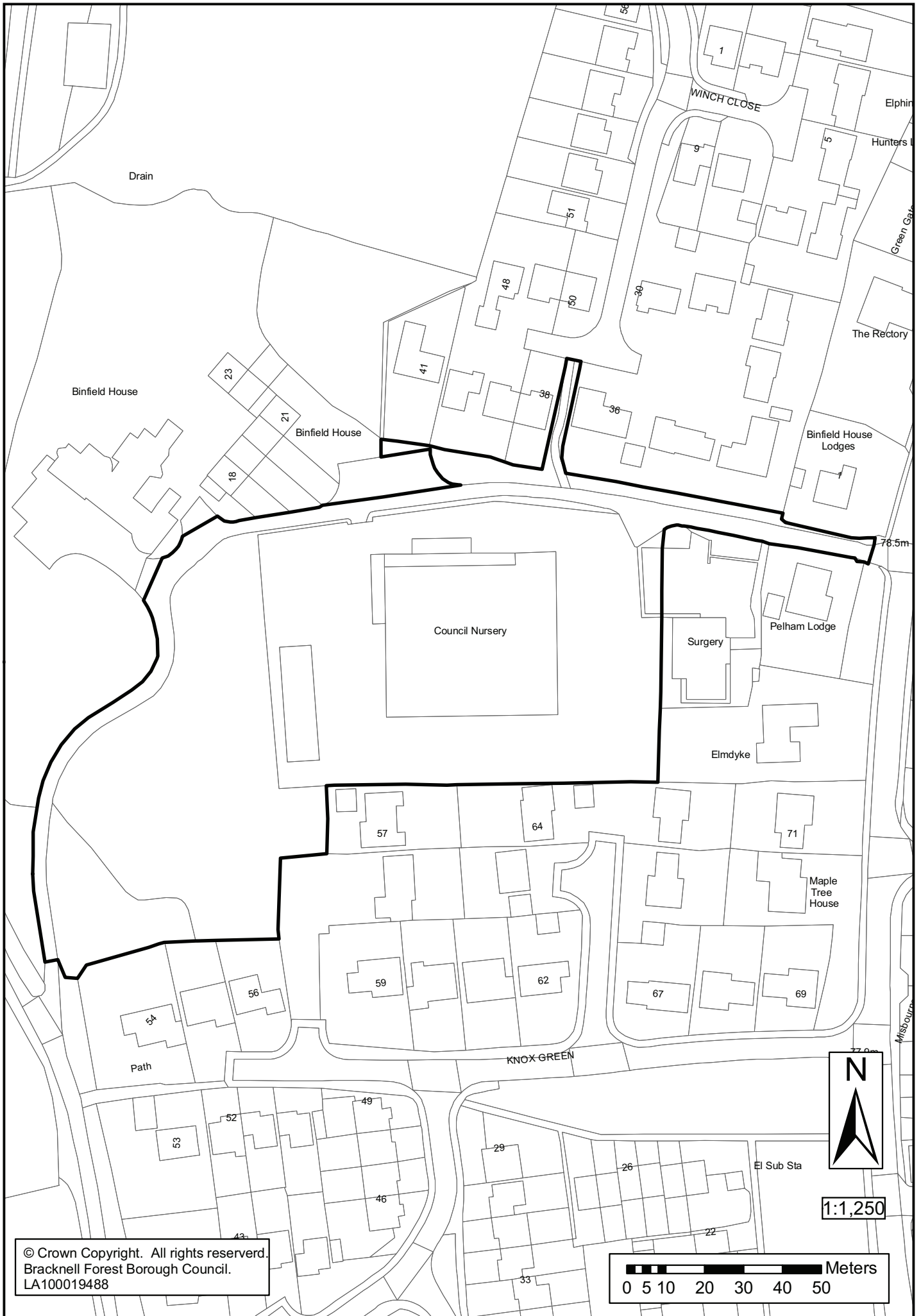

This page is intentionally left blank